



Installation Instructions

718149

2022-2026 Nissan Frontier
With 3.8L Engine

2- or 4-Wheel Drive

Crew Cab Short Bed- King Cab Long Bed

Installation requires moderate mechanical skill. If this job is beyond your abilities, seek the services of a qualified technician.

If you do not understand any part of these instructions, please call Flowmaster Technical Support at (866) 464-6553 for assistance.

Apply penetrating oil generously to clamps, fasteners, pipes, and hanger rods for ease of disassembly.

REVIEW THE INSTRUCTIONS & VERIFY THE KIT CONTENTS

Take a moment to read and understand these instructions before installing your Flowmaster exhaust kit.

ITM#	Part #	Description	Qty.
1	86748M	Left Front Inlet pipe	1
2	86749M	Left Rear Inlet Pipe	1
3	86747M	Right Inlet Pipe	1
4	MC250BS	Stainless Band Clamp	5
5	72468-Z	Muffler	1
6	86762M	Tail Pipe assembly	1
7	HW505	CABLE TIE	2

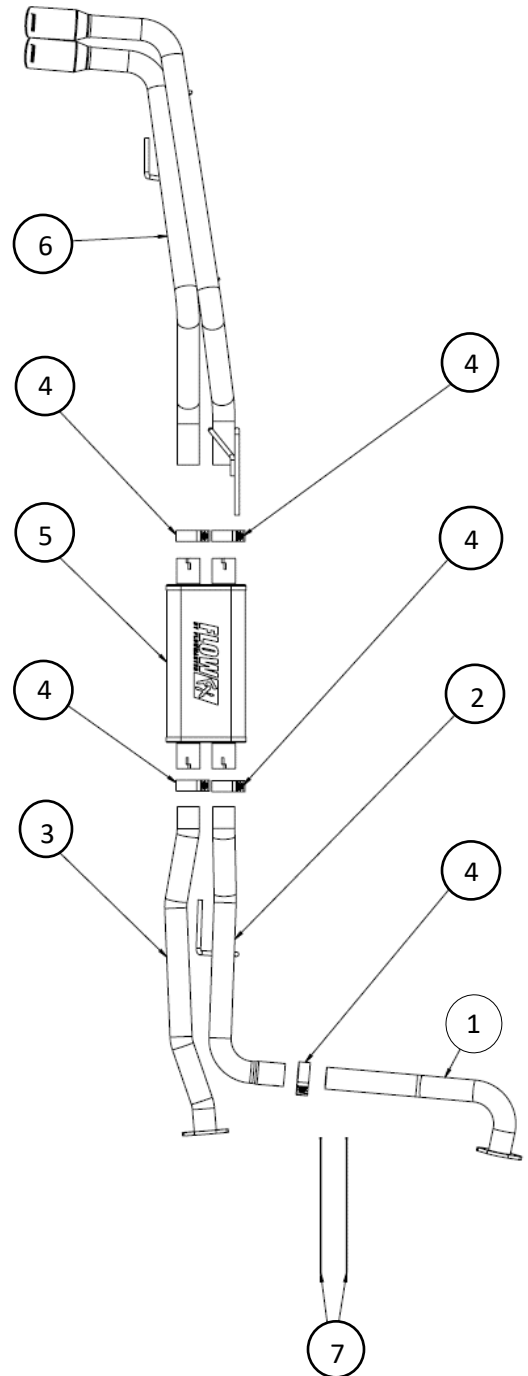

Use the parts drawing and list to verify your kit's contents. In the unlikely event that any parts are missing, please contact Flowmaster Technical Support for replacements.

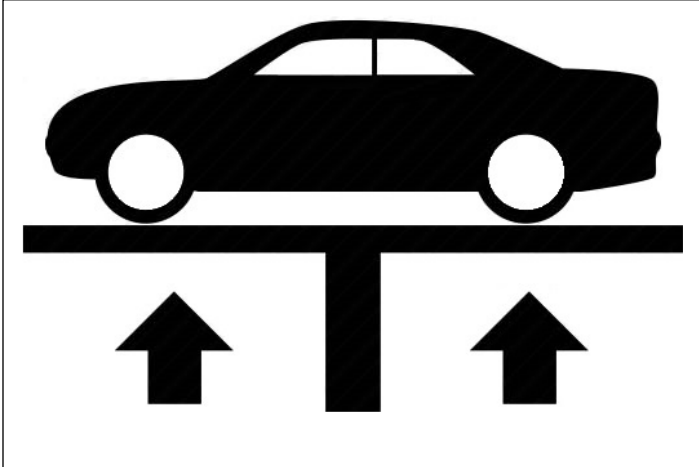

Vehicle Compatibility

Model Year: 2022-2026

Make: Nisan Frontier

Engine: 3.8L V6 (NA)

- Crew Cab Short Bed
- King Cab Long Bed

BEFORE STARTING:

Raise the vehicle a minimum of 18 inches. A floor hoist is ideal. If no hoist is available, we strongly urge the use of axle stands as a safety measure.

Please read and understand these instructions and disclaimer in their entirety before attempting installation.

CAUTION! WORK ONLY ON A SOLID, LEVEL SURFACE. USE JACKS /JACK STANDS OF SUFFICIENT CAPACITY TO LIFT AND SUPPORT YOUR VEHICLE. NEVER WORK UNDER A VEHICLE SUPPORTED BY A FLOOR OR BUMPER JACK.

Removing the OEM Exhaust.

1. Apply Penetrating oil to the (x4) 14mm nuts at the inlet pipe flanges, Band clamp on the tail pipe and each rubber Hanger on the exhaust.
2. Loosen the band Clamp on the tail pipe just after the rear axle and apply penetrating oil to the slip joint.
3. Remove the (X3) M8 bolts from the tail pipe hanger assembly bolted to the frame just over the axle . **Fig.1**
4. Remove the rubber tail pipe hanger and remove the tail pipe. **Fig. 1**
5. Re install the tail pipe hanger

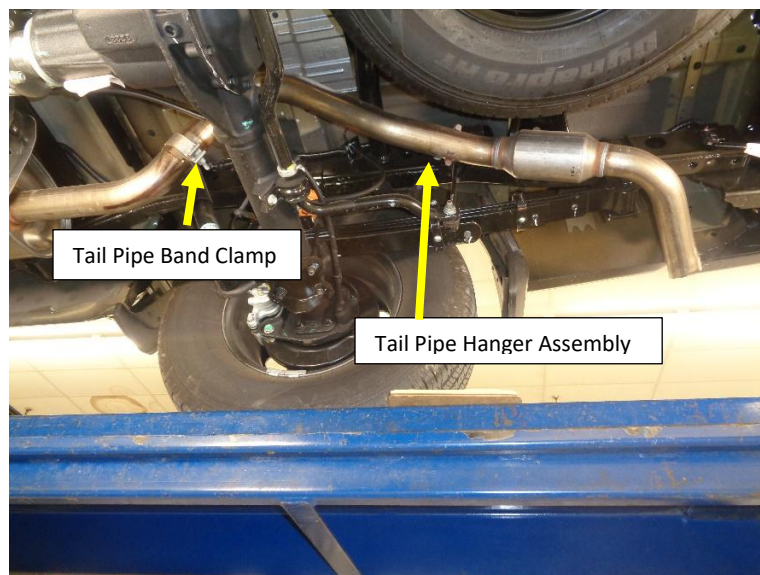

Figure.1

Removing the OEM Exhaust Cont'd

6. Remove the (x2 each) 14mm nuts at the flanges connecting the muffler inlet pipes to the catalytic converter. **Fig.2**
Note: The nuts are very tight from the factory and will require a decent quality deep socket for removal.
7. Support the muffler and inlet pipe assembly.
8. Apply Spay lube to the remaining (2) muffler hanger rods and rubber isolator.
9. Carefully Remove the inlet Pipes and Muffler assembly by sliding the assembly back towards the rear of the vehicle until the hanger rods are out of the rubber isolators. Take care not to damage the thin metal gaskets at the flanges, they will be re used later.

Caution: This assembly is heavy and awkward to manage with one person. Have a second person available to help with this process and avoid possible injury.

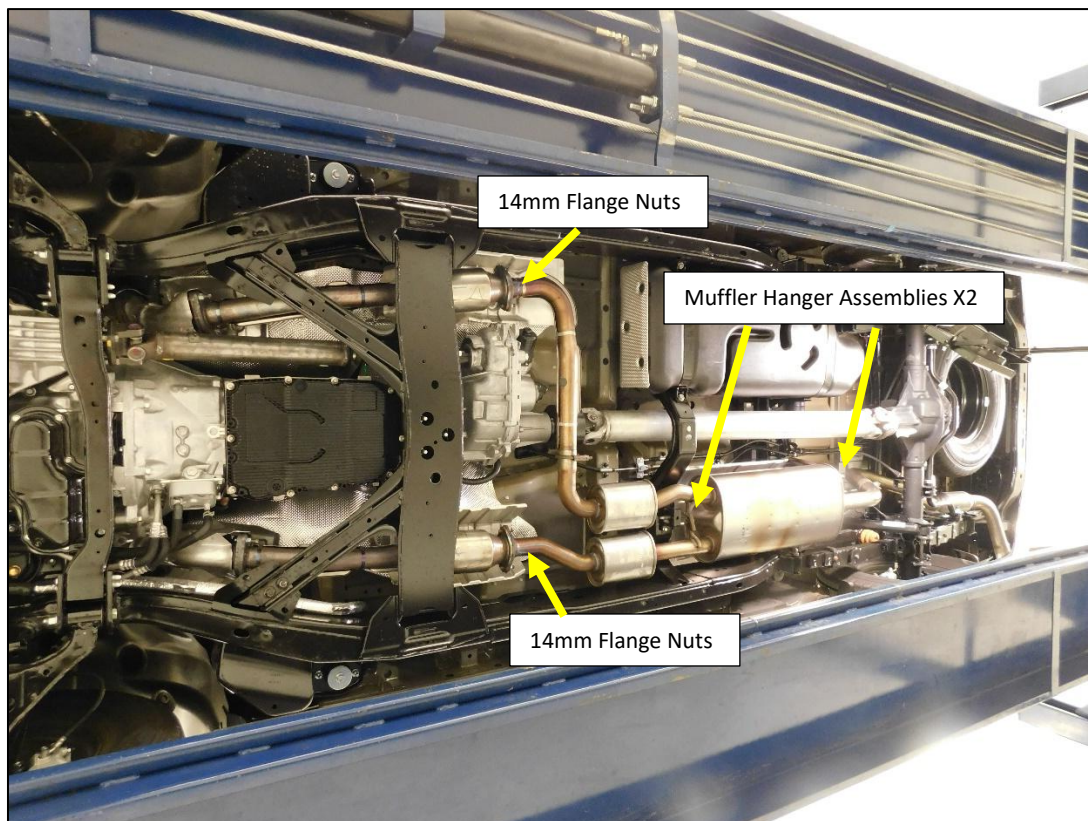

Figure.2

INSTALL YOUR FLOWMASTER EXHAUST SYSTEM



Before installing clamps in the following steps, remove their nuts, apply anti-seize compound to the bolt threads, and re-install the nuts.

1. Install the OEM metal gaskets on to the studs of the catalytic converters if removed.
2. Install the hanger rod of the left rear inlet pipe **(2)** into the front muffler hanger rod Isolator at the crossmember **(A)**. Be sure to use the center round isolator hole.
3. Install a 2.5" band clamp **(4)** on to the expanded end of the Left Rear inlet pipe **(2)**.
4. Install the Left Front Inlet pipe **(1)** into the expended end of the left rear inlet pipe **(2)**. Align the flange to the studs on the catalytic converter. Install (x2) 14mm nuts and tighten enough to pull the flanges together but still allow for adjustment.
5. Tighten the band clamp **(4)** to hold the pipe but allow for adjustment
6. Install the Right Inlet pipe **(3)** on to the studs of the right side catalytic converter. Install (x2) 14mm nuts and tighten enough to pull the flanges together but still allow for adjustment.
7. Install a 2.5" band clamp on to each muffler inlet pipe **(4)**. Position with the bolts on the passenger side and nuts facing down.

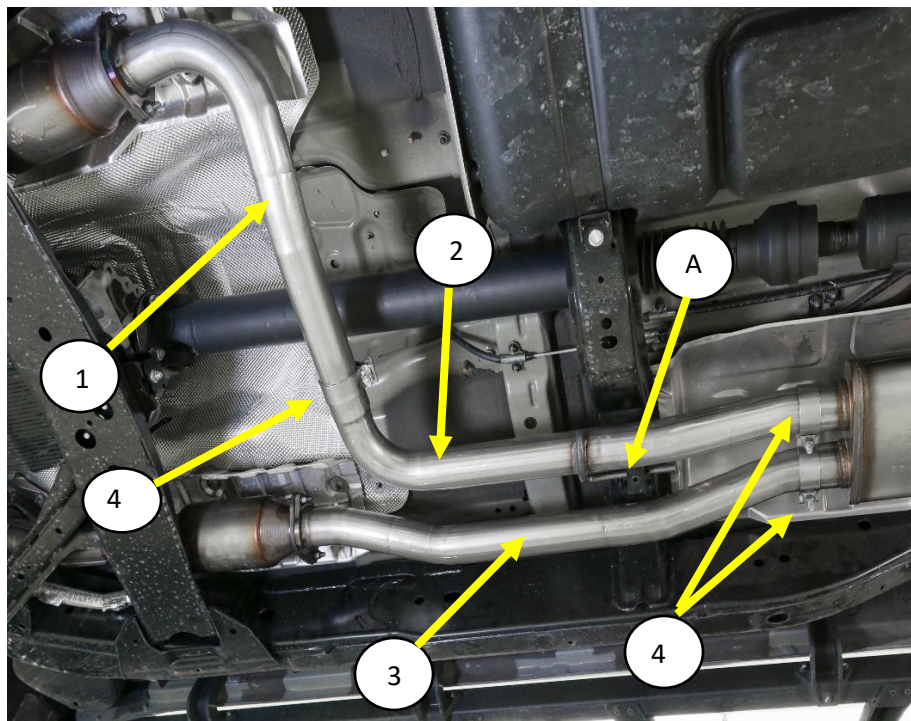

Figure.3

Installation Continued

8. Install the FlowFX Muffler **(5)** on to the inlet pipes with the seam to the inside and the Flow FX logo running front to back. Support the muffler from hanging on the inlet pipes. **Fig.4**
9. Tighten the clamps at the muffler inlet pipes to hold the muffler in place and allow for adjustment.
10. Install a supplied 2.5" band clamp **(4)** over each muffler outlet. Position with the bolts on the passenger side and nuts facing down.
11. Install the tail pipe assembly **(6)** over the axle, Install the hanger rod at the back of the tail pipe into the tail pipe hanger isolator on the frame rail **(C)**. **Fig.4**
12. Align the tail pipe hanger rod **(B)** to the isolator above the muffler and the tail pipe to the muffler outlets, install the tail pipes into the muffler and hanger rod into the isolator. Tighten the clamps to hold the tail pipe to allow for adjustment.

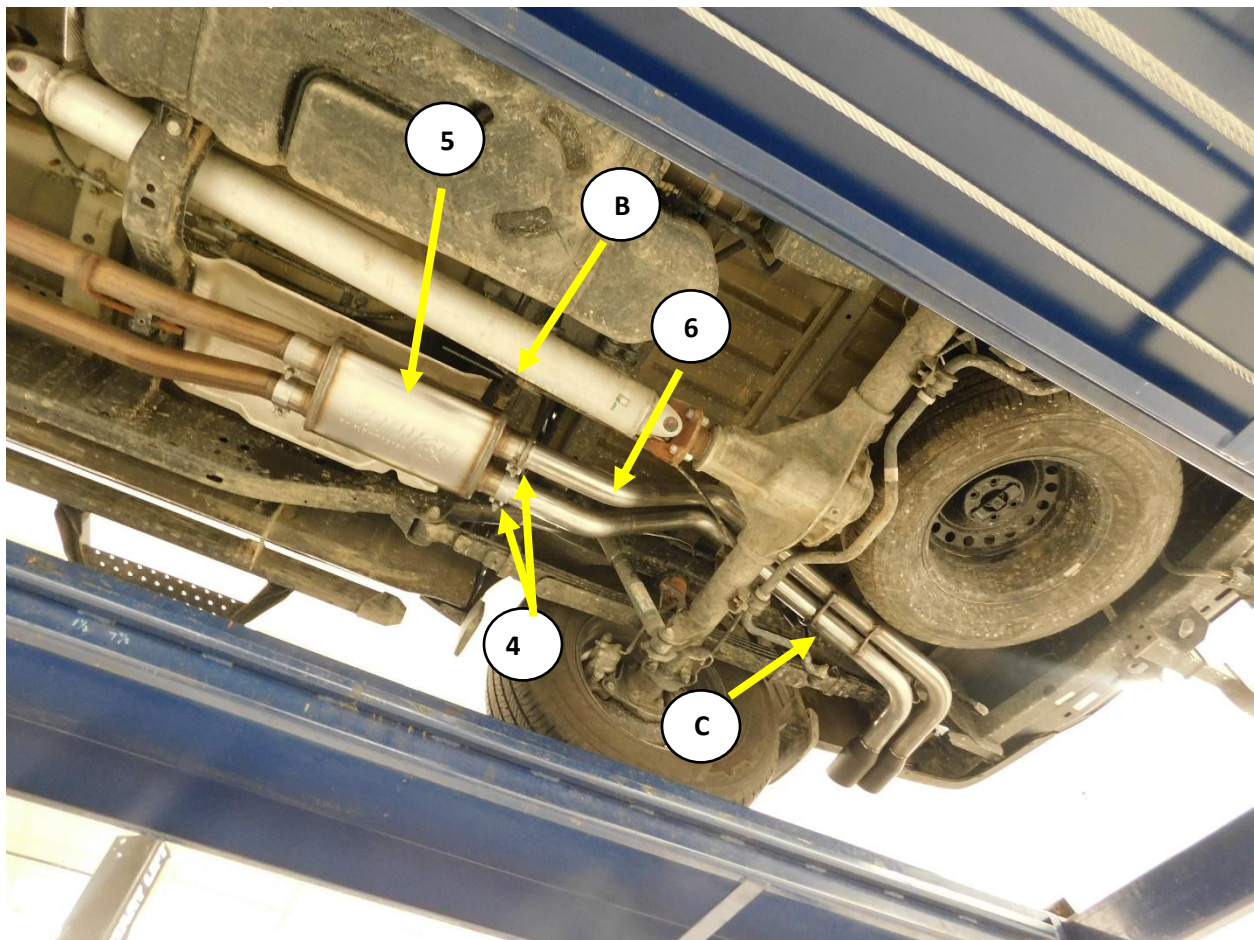

Figure. 4

Installation Continued

13. Secure the ABS Cable and Brake Hose away from the tail pipe assembly using the supplied cable ties (7). Loop the cable ties through the brackets on the frame and loosely adjust the cable ties for adequate clearance but still allow free movement with suspension travel. **Fig.5 /Fig.6**
Fig. (4)(5) *Do Not tie them tight to the frame.

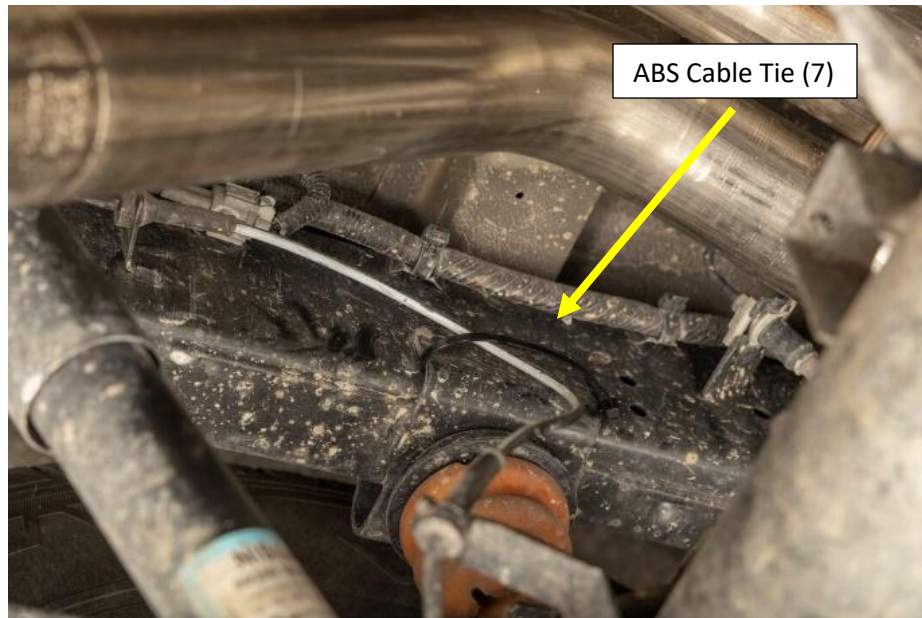

Figure. 5

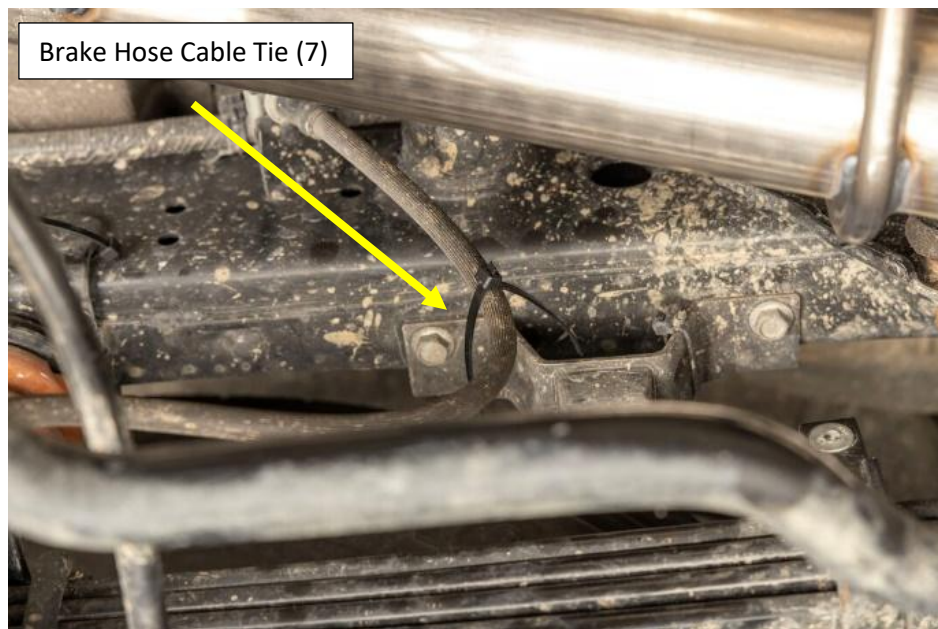

Figure. 6

14. Adjust the exhaust for the best fitment and clearance, Tighten the hardware and clamps starting at the front and work your way to the rear of the vehicle.
15. Install the Push Nuts to the hanger rods.



Enjoy Your Flowmaster Exhaust!