



# Installation Instructions

## 718195

**Direct Fit Muffler**  
**2025 - 2026 RAM 1500**  
**Standard Output**  
**3.0L Turbo I6 Engine**

Installation requires moderate mechanical skill. If this job is beyond your abilities, seek the services of a qualified technician.

If you do not understand any part of these instructions, please call Flowmaster Technical Support at (866) 464-6553 for assistance.

Apply penetrating oil generously to clamps, fasteners, pipes, and hanger rods for ease of disassembly.

### REVIEW THE INSTRUCTIONS & VERIFY THE KIT CONTENTS

Take a moment to read and understand these instructions before installing your Flowmaster exhaust kit.

ITM#	Part #	Description	Qty.
1	72198-622	25 RAM Direct Fit Muffler	1
2	MC250BS	2.50" Stainless Band Clamp	1
3	HW224	7/16 Hex Bolt	2
4	HW304	7/16 Flat Washer	4
5	HW310	7/16 Lock Washer	2
6	HW104	7/16 Hex Nut	2
7	HW503	7/16 Push Nut	3

Use the parts drawing and list to identify components and verify your kit's contents. In the unlikely event that any parts are missing, please contact Flowmaster Technical Support for replacements.

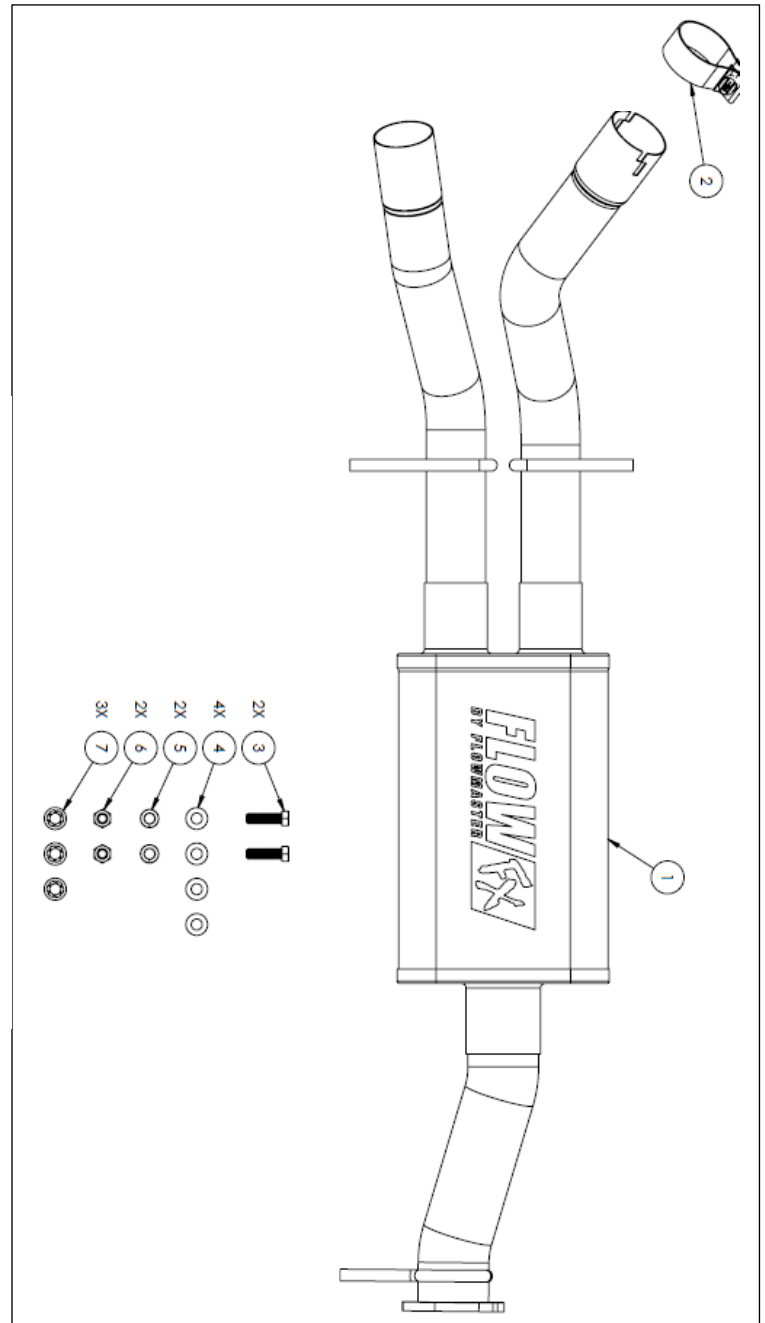

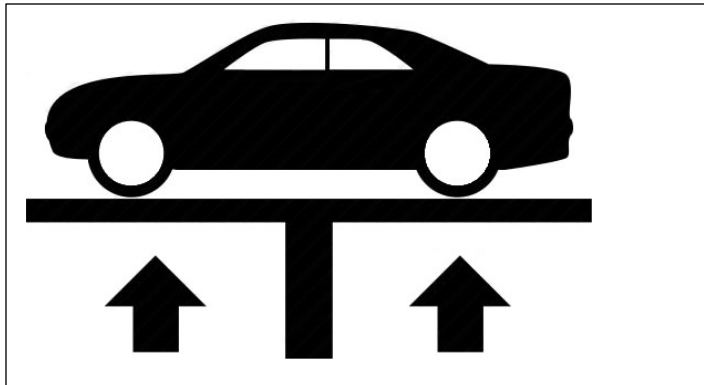

## Vehicle Compatibility

Model Year: 2025 - 2026

Make: RAM

Model: 1500

Engine: 3.0L Twin Turbo I6

- Standard Output Engine
- All Wheel Bases

**\*\*Will Not Work with High Output Engine**

### BEFORE STARTING:

Raise the vehicle to a minimum of eighteen inches. A floor hoist is ideal. If no hoist is available, we strongly urge the use of axle stands as a safety measure. **Please read and understand these instructions and disclaimer in their entirety before attempting installation.**

**CAUTION! WORK ONLY ON A LEVEL SURFACE. USE JACKS /JACK STANDS OF SUFFICIENT CAPACITY TO LIFT AND SUPPORT YOUR VEHICLE. NEVER WORK UNDER A VEHICLE SUPPORTED BY A FLOOR OR BUMPER JACK**

### Removing the OEM Exhaust:

**NOTE: Cutting the factory exhaust is necessary. Please read and follow all instructions before attempting to install this exhaust system.**

### Removing the OEM Muffler Assembly

1. Apply penetrating oil to the rubber isolator at the 2-bolt flange. **See figure.5 (B)**
2. Support the exhaust assembly before making cuts or removing any rubber hangers.
3. Cut the left (Drivers Side) tail pipe at the location in **Fig. 1/ Fig. 2**
  - Measure from the clamp mark closest to the bend on the tailpipe and make a witness mark at 3 1/4". **Fig.2**
  - Wrap masking tape around the pipe at the mark to use as a straight edge for making a clean cut.
  - Cut the pipe at the mark, following the tape edge as you go.
  - Deburr the tail pipe inside and out.

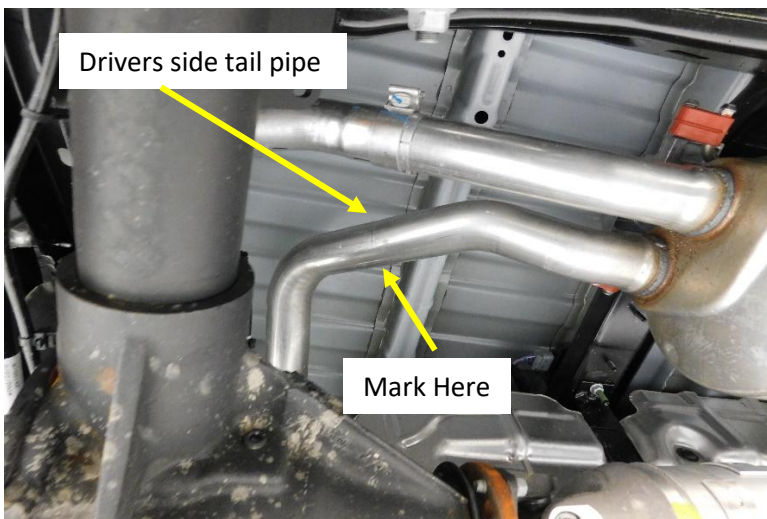

Figure. 1



Figure.2

## Removing the OEM Muffler Assembly Cont'd

4. Remove the (2x) bolts at the Muffler inlet pipe Flange. **Fig. 3**
5. Loosen the Clamp at the right tail pipe connection just before the axel and spray with penetrating oil.
6. Spray the isolator with penetrating oil.
7. Work the right tail pipe off the muffler assembly.
8. Remove the (2x) 13mm nuts securing the muffler hanger bracket over the rear of the Muffler. **Support the Muffler!**
9. Remove the OEM Muffler assembly from the vehicle.

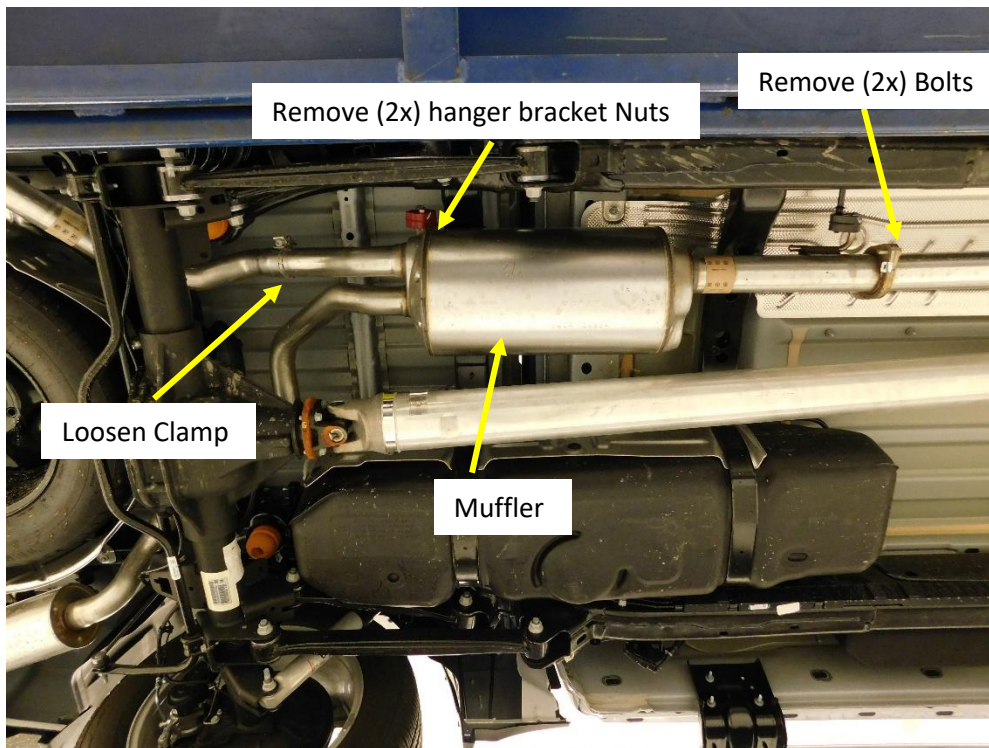

**Figure.3**

10. Remove the rear hanger assembly and Isolators from the muffler and save for reuse later.
11. Remove the muffler inlet pipe isolator and re-install it on the frame.
12. Remove the metal gasket from the OEM flange and transfer it to the 718195, muffler inlet pipe flange.

## 718195 Installation

1. Install the 2.5" band clamp **(2)** on to the 718195 Direct fit muffler left tail pipes expanded end. Position the clamp with the bolt towards the rear of the vehicle and nut facing down. **Fig.4**
2. Install the Muffler hanger bracket **(A)** on to the tail pipe hanger rods. Be sure the bracket is facing the correct way. **Fig. 4**
3. Position the muffler assembly into the vehicle and align the left and right Muffler outlet pipes to the Left and Right tail pipes. Work the tail pipes into the slip joints working left to right as they begin to slip together. Do not tighten the clamps . **Fig.4**
4. Align the Muffler inlet pipe hanger rod **(B)** to the isolator on the frame at the flange. Install the hanger rod into the isolator. **Fig.5**
5. Align the Muffler rear hanger assembly **(A)** to the studs on the frame and install the (2x) 13mm nuts. **Fig.4**
6. Install a 7/16 flat washer **(4)** onto each provided 7/16 Hex bolt **(3)**. Install the bolts at the flange connection between the muffler and the OEM pipe **(C)**. Be sure the metal gasket is in place. **Fig.5**
7. Install a flat washer **(4)** Lock washer **(5)** and nut **(6)** on to the bolt at the opposite flange. Tighten the bolts to hold the assembly in place but allow for adjustment.

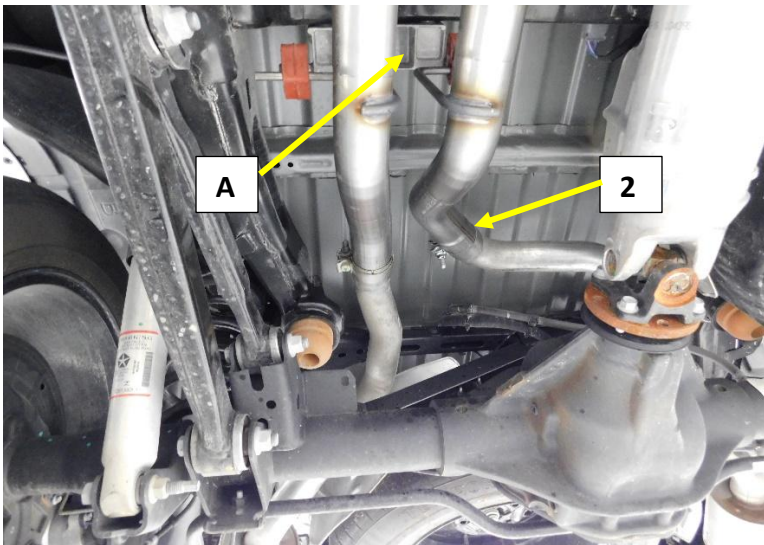

Figure. 4

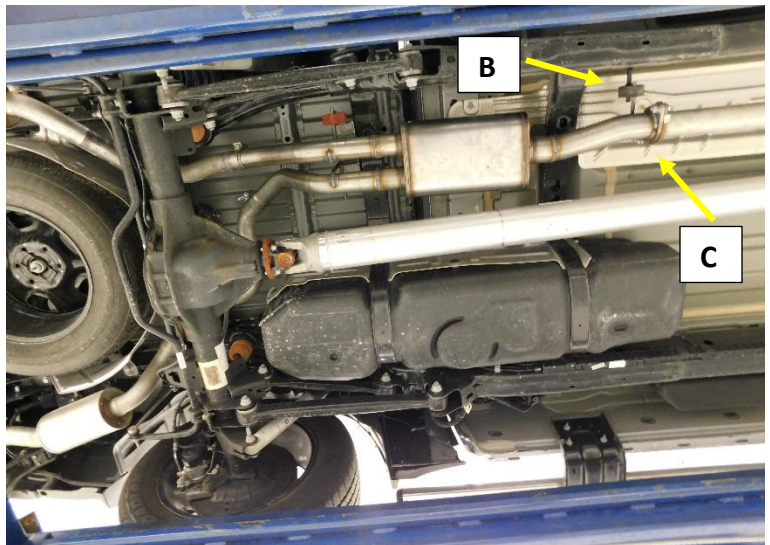

Figure. 5

8. Align the tail pipes and tips, tighten the band clamps on the tail pipes.
9. Tighten the bolts at the flange connection.
10. Double check alignment and recheck all hardware.
11. Final tip alignment can be made at the tip clamp connection if necessary.

# Enjoy Your Flowmaster Exhaust!

