

# Instructions

## Rear Control Arm Bushings

**N.B:** This instruction sheet should be used in conjunction with the workshop manual and proper safety procedures followed.

- Raise vehicle evenly and safely support.

*Never rely on a Jack only*

- Proceed to remove rear wheels.

**Remove and service only one arm at a time.**

**Note - for lower arms, press out complete bushing including steel outer shell.**

**For Upper arms, there is no steel outer shell  
- simply push old rubber out.**

- Once bushings are removed, clean Eyes of any grease and oil.

- Refer bushing orientation below. Grease bushing internal diameter and outer side face with supplied grease only.

- Re-fit arms with original bolts
- Re-check all bolts after 100kms

**Application** - Toyota 4Runner  
- 1998-2002

*(Refer current catalogue for complete listing)*

**Contents** - Bushing 91822 x4  
- Bushing 91823 x8  
- Bushing 91824 x4  
- Bushing 91825 x8  
- Steel tube 19x12.2x54mm x4  
- Steel tube 22.2x14.3x59mm x4  
- Grease

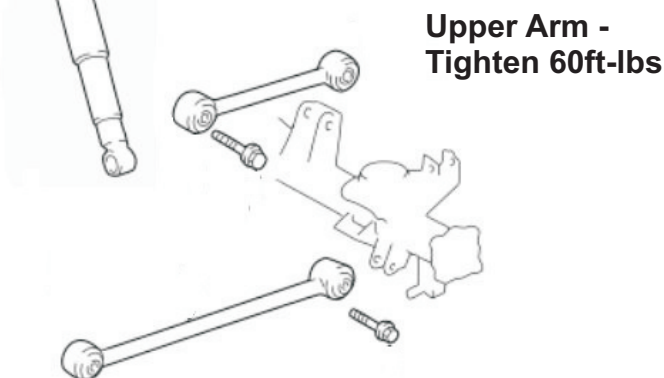
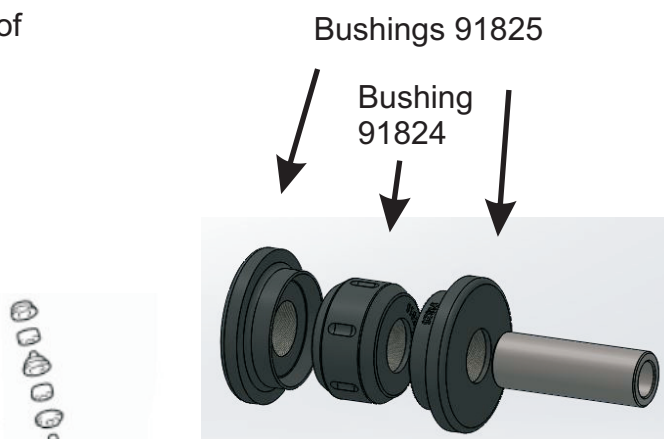
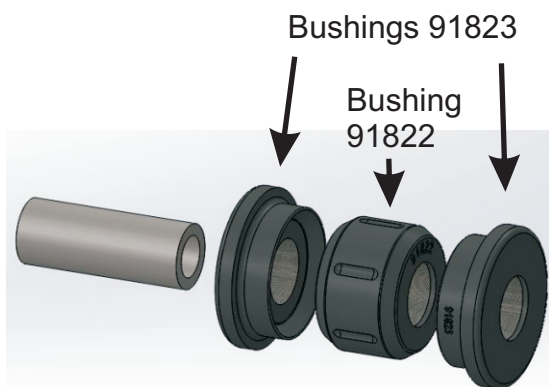

**Lower Arm -  
Tighten 100ft-lbs**

**N.B:** It is recommended that a licenced workshop or tradesperson carry out the above procedure and that workshop manual and relevant safety procedures are followed in addition to the above.