

Instructions

Front Control Arm Bushings

N.B: This instruction sheet should be used in conjunction with the workshop manual and proper safety procedures followed.

- Raise vehicle evenly and safely support with stands.

Never rely on a Jack only

Note - lubricate all bolts prior to removal

- Proceed to un-bolt upper control arms.

**IMPORTANT - remove rubber only from bushings.
DO NOT remove outer steel shell from either upper or lower arms.**

Upper Arm - IMPORTANT - once rubber is removed, place Arm in Press and press existing shell in - so shell sits closer to Arm (shell will move 1-2mm)

This will make install of Arm easier.

- Push in supplied bushings. Grease bushing internal diameter and face with supplied grease only.
- Note - for upper bushings, use supplied washer against bushing face. Also use supplied steel tubes.
- For lower arm, re-use OE washers and steel tubes.
- Re-fit arms and carry out a wheel alignment immediately after install.
- Re-check all bolts after 100kms travelled.

Application - Toyota Tacoma
- 2WD and 4WD

Always refer complete catalogue listing

Contents - Bushing 91395 x4
- Bushing 91396 x4
- Steel tube 19x14x52 x4
- Washer 53x14x3 x4
- Grease

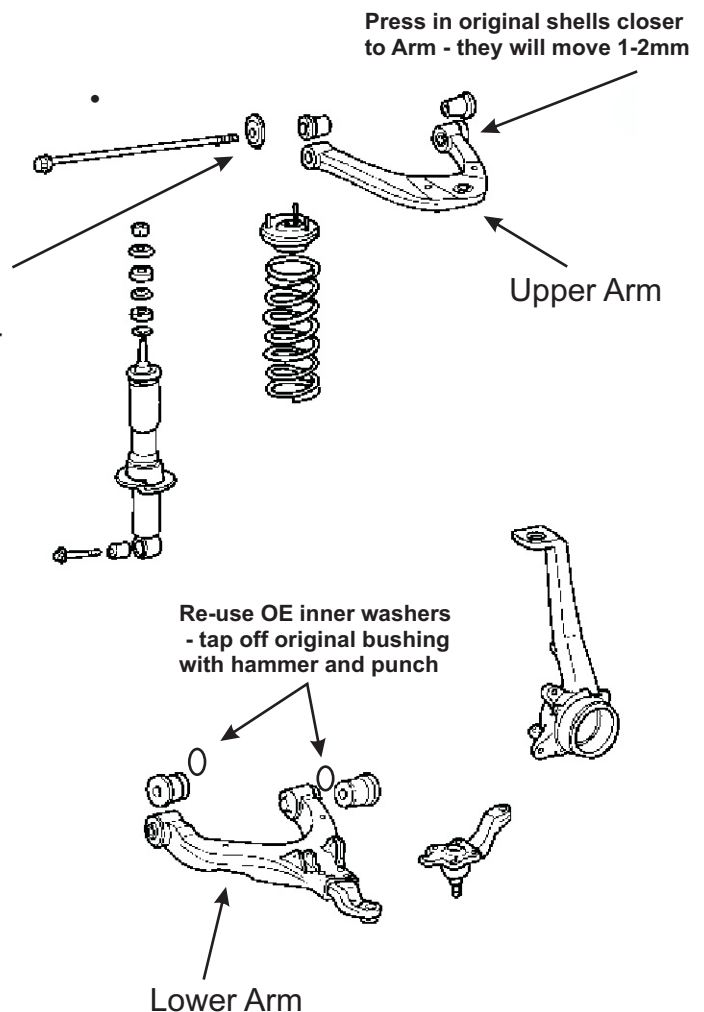

N.B: It is recommended that a licenced workshop or tradesperson carry out the above procedure and that workshop manual and relevant safety procedures are followed in addition to the above.

Instructions

Front Control Arm Bushings

N.B: This instruction sheet should be used in conjunction with the workshop manual and proper safety procedures followed.

Continued - page 2 of 2;

- Refer bushing number with position on vehicle below.

- Re-check all bolts after 100kms travelled.

Please drive safely while you accustom yourself yo the vehicles changed behaviour