

Instructions

Rear Control Arm Bushings

N.B: This instruction sheet should be used in conjunction with the workshop manual and proper safety procedures followed.

- Raise vehicle evenly and safely support.
Never rely on a Jack only.

Note - this is an in-depth job - we suggest only dismantling if you are familiar with this work

- Remove and service only one control arm at a time.
- Original bushings will have to be pressed out or alternatively, drill hole in rubber and use air-hacksaw to cut slit in steel outta shell.
- Clean all eyelets well from dirt or oil.
- For 1-piece bushing - press in with soapy water.
- Refer diagram below for bushing placement and greasing.
- Re-fit all arms with original bolts - tighten to manufacturers spec.
- A wheel alignment is required immediately after install.

Application: - Toyota Supra MA71
- 1987-1992

Contents: - Bushing 91732 x8
- Bushing 91733 x4
- Bushing 91734 x4
- Bushing 91735 x4
- Bushing 91736 x4
- Bushing 91737 x2

- Steel tube 22.2x14.3x45.5 x2
- Steel tube 22.2x14.5x48 x2
- Steel tube 22.2x14.3x50 x10
- Grease

Grease new bushing internal diameter and side face with supplied grease only

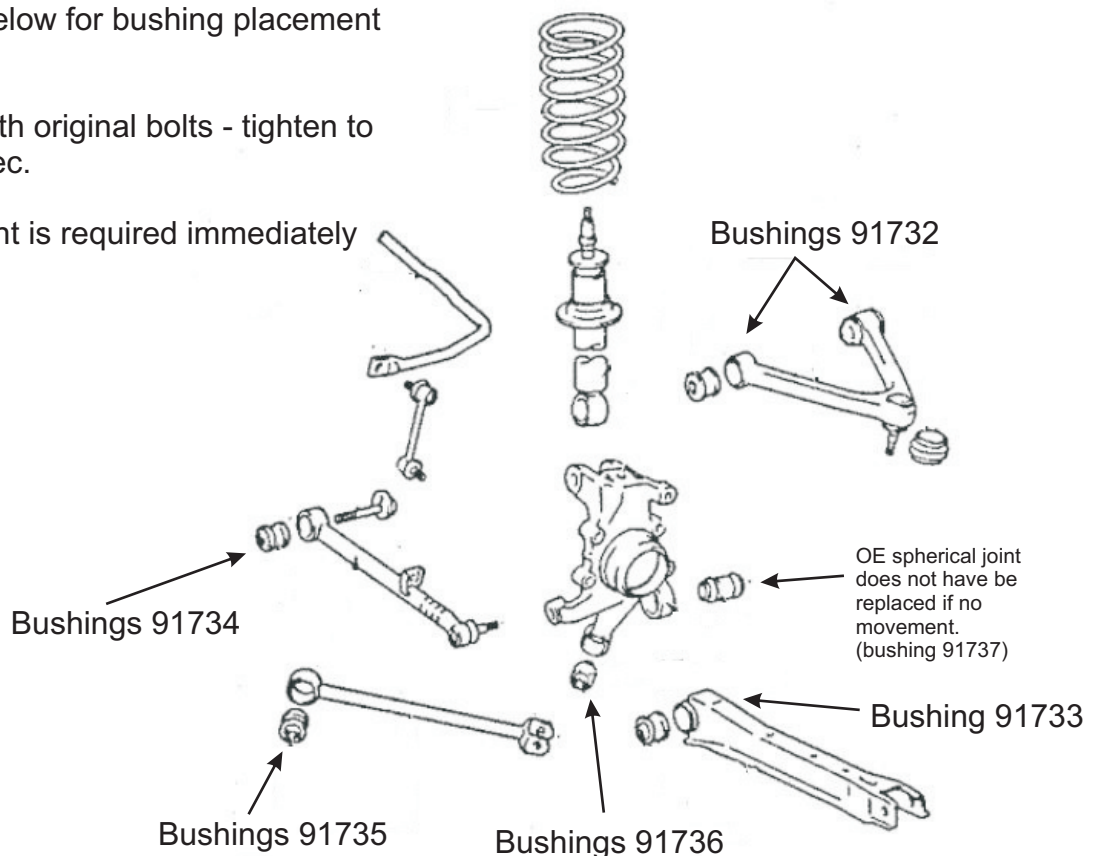
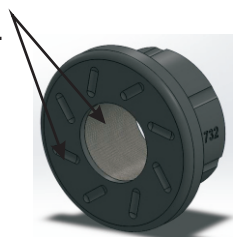

N.B: It is recommended that a licenced workshop or tradesperson carry out the above procedure and that workshop manual and relevant safety procedures are followed in addition to the above.