

Instructions

Front Control Arm Bushings

N.B: This instruction sheet should be used in conjunction with the workshop manual and proper safety procedures followed.

- Raise vehicle evenly and safely support.

Never rely on a Jack only.

- Proceed to remove front wheels.

NOTE - a Press will be required to press out old lower rear bushings.

• For lower front and upper bushings, drill a hole in rubber and use hacksaw to cut outer shell.

- Start by removing only 1 arm at a time.
- Press or cut-out old bushings (careful to not damage OE arm)
- Press in the lower rear bushing 91774 with soapy water.
- Grease bushing ID and side face with supplied grease only.

Application - Mazda MX5 (Miata)
- 2006-14

Always refer complete catalogue listing

Contents - Bushing 91773 x4
- Bushing 91774 x2
- Bushing 91775 x2
- Bushing 91776 x2
- Steel tube 28.6x14.4x60
- Steel tube 22.2x12.2x54.7
- Grease

Bushing 91774

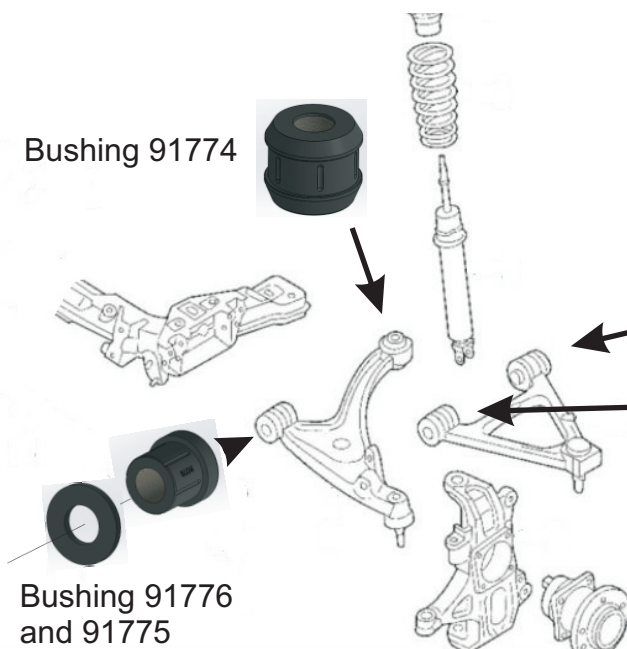

Bushing 91776
and 91775

- Push in supplied steel tubes - and re-fit arms to vehicle.

• A wheel alignment will be required immediately after install.

- Re-check all bolts after 100 miles

Bushings 91773

Note - the shock bushing is not included in this kit.

N.B: It is recommended that a licenced workshop or tradesperson carry out the above procedure and that workshop manual and relevant safety procedures are followed in addition to the above.