

Instructions

Rear Control Arm Bushings

N.B: This instruction sheet should be used in conjunction with the workshop manual and proper safety procedures followed.

Page 1 of 2

- Raise vehicle evenly and safely support.

Never rely on a Jack only.

- Proceed to remove the rear wheels.

Note - it is best to mark the eccentrics before dismantle - this will mean the car can be driven to a wheel aligner.

- Remove and service only 1 arm at a time.

• Remove the rubber only from control arms. Use a Press or heat to delaminate and remove rubber.

Application - Mazda MX5 (Miata)
- 2006-14

Always refer complete catalogue listing

Contents - Bushing 91782 x4
- Bushing 91783 x4
- Bushing 91784 x4
- Bushing 91785 x4
- Bushing 91786 x8

- Steel tube 19x12x55 x2
- Steel tube 22x16x43 x2
- Steel tube 25x14x60 x2
- Steel tube 19x12x47 x2
- Steel tube 22x12x48 x4

- Stepped washers x4

- Grease

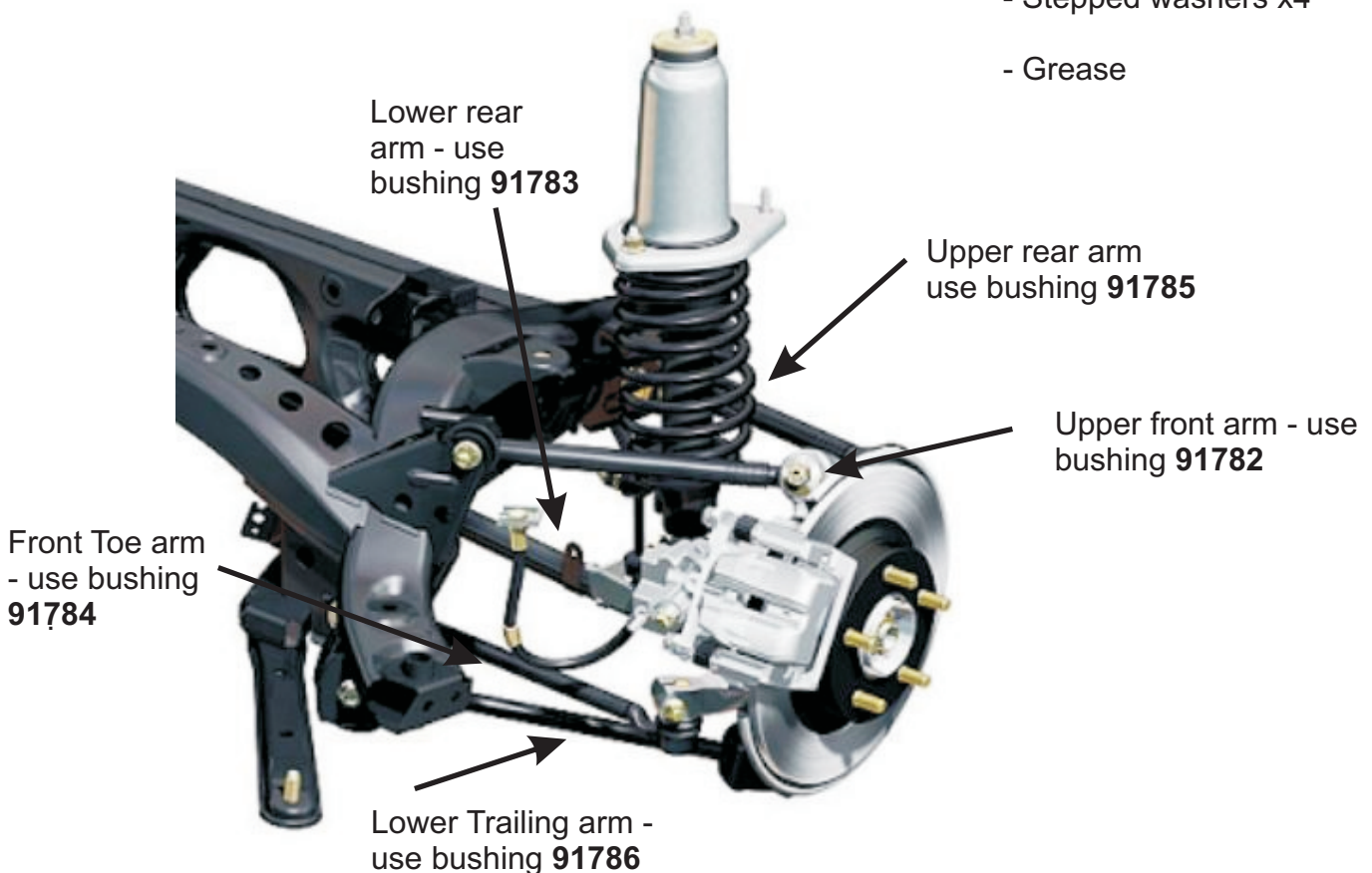

N.B: It is recommended that a licenced workshop or tradesperson carry out the above procedure and that workshop manual and relevant safety procedures are followed in addition to the above.

Instructions

Rear Control Arm Bushings

N.B: This instruction sheet should be used in conjunction with the workshop manual and proper safety procedures followed.

Continued - page 2 of 2

- Push new bushings into control arm eye as per below.
- Grease bushing internal diameter and side face with supplied grease only.
- Push in steel tubes and re-fit to vehicle.

Note - use supplied stepped washers on front Toe Arm. place against bushing face as per below -

- Tighten up all arms with original bolts. Note - torque settings below.
- Road test and carry out a wheel alignment immediately.
- Re-check all bolts after 100 miles.

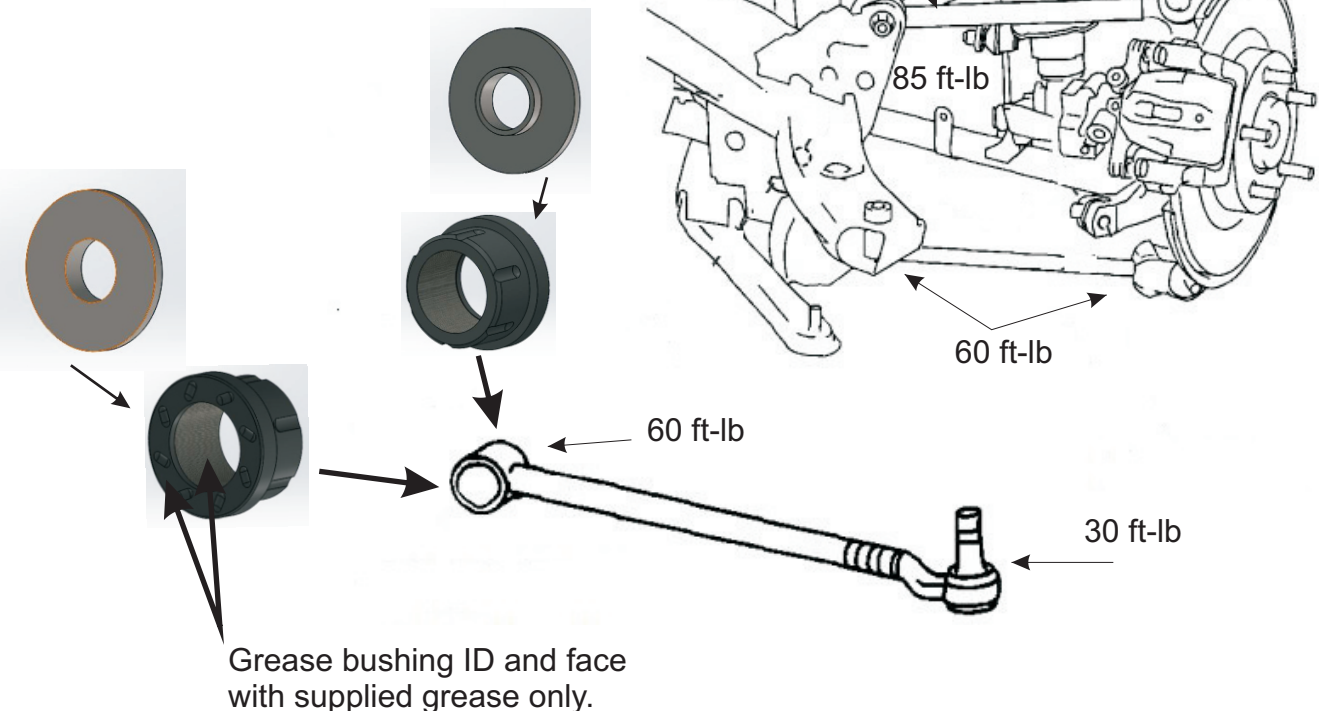

N.B: It is recommended that a licenced workshop or tradesperson carry out the above procedure and that workshop manual and relevant safety procedures are followed in addition to the above.