

BRExhaust™

A **MAGNAFLOW** GROUP COMPANY

INSTALLATION INSTRUCTIONS | PART NO. 106-0819

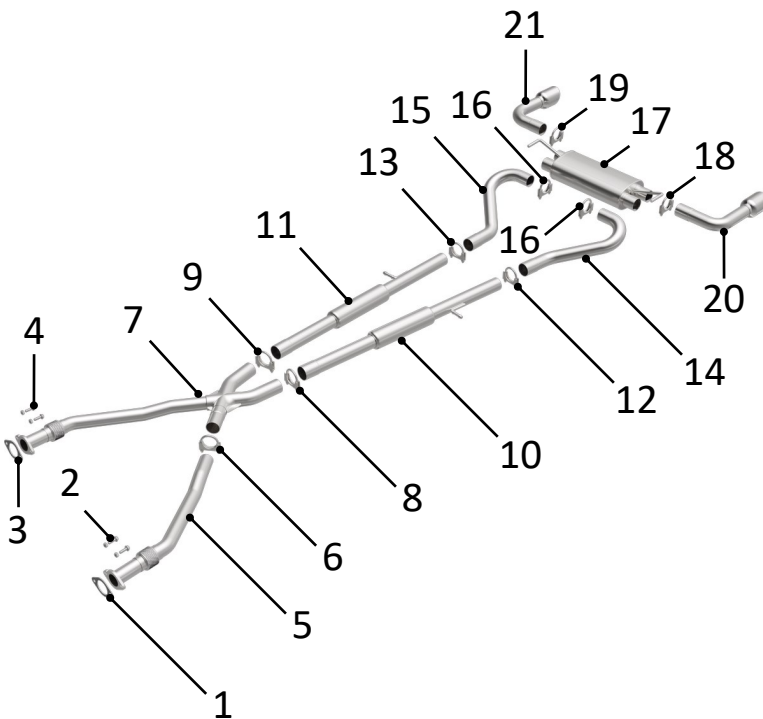

STEP 1: (Carefully read all instructions before installation)
Disconnect the vehicle's battery before removal of the OEM exhaust system. This will prevent electrical accidents and will reset the computer if it applies to the vehicle. Remove existing exhaust system from the vehicle. Only remove parts that will be replaced. Clean existing flange with a wire brush to ensure proper sealing.

STEP 2: Attach the **[5] Inlet Assembly** to the existing exhaust with supplied **[2] Hardware** and **[1] Gasket** and also to the **[7] X-Pipe Assembly** with supplied **[6] Clamp** while also attaching the **[7] X-Pipe Assembly** to the existing exhaust with supplied **[4] Hardware** and **[3] Gasket**.

STEP 3: Attach driver side **[10] Resonator Assembly** to existing isolator and **[7] X-Pipe Assembly** with supplied **[8] Clamp**.

STEP 4: Attach passenger side **[11] Resonator Assembly** to existing isolator and **[7] X-Pipe Assembly** with supplied **[9] Clamp**.

STEP 5: Attach driver side **[14] Mid Pipe** to driver side **[10] Resonator Assembly** with supplied **[12] Clamp**.

STEP 6: Attach passenger side **[15] Mid Pipe** to passenger side **[11] Resonator Assembly** with supplied **[13] Clamp**.

STEP 7: Attach **[17] Muffler Assembly** to existing isolators and both driver side **[14] Mid Pipe** and passenger side **[15] Mid Pipe** with supplied **[16] Clamps**.

STEP 8: Attach driver side **[20] Tail Pipe Assembly** to **[17] Muffler Assembly** with supplied **[18] Clamp**.

STEP 9: Attach passenger side **[21] Tail Pipe Assembly** to **[17] Muffler Assembly** with supplied **[19] Clamp**.

STEP 10: Ensure new exhaust is not contacting any portion of the underbody of the vehicle or drivetrain.

STEP 11: Tighten all clamps starting from rear of the vehicle. (**DO NOT EXCEED 30FT-LB WHEN TIGHTENING CLAMP AND CHECK ALL CLAMPS AFTER 50 MILES. RETIGHTEN IF NECESSARY**)

WARNING:

When working on, under, or around any vehicle exercise caution. Please allow the vehicle's exhaust system to cool before removal, as exhaust temperatures may cause severe burns. If working without a lift, always consult vehicle manual for correct lifting specifications. Always wear safety glasses and ensure a safe work area. Serious injury or death could occur if safety measures are not followed.



BRExhaust recommends
professional installation
for all products

Technical Support: 1-800-631-7271

BRExhaust — 1901 Corporate Ctr, Oceanside, CA 92056

www.brexhaust.com

REV #000 DATE 6./12/2023